

4611110008158

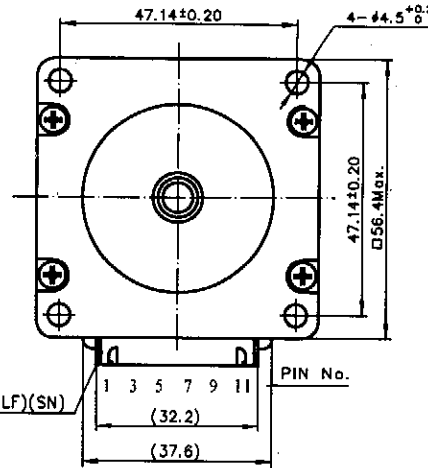

接线图
Wiring Diagram

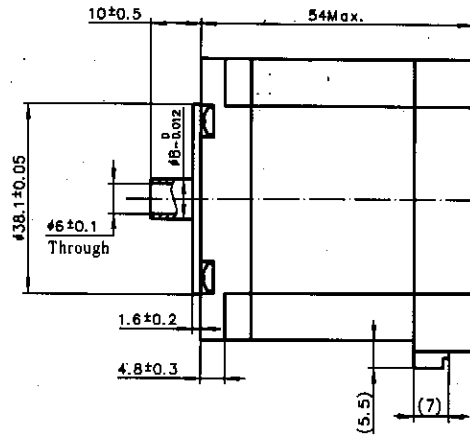
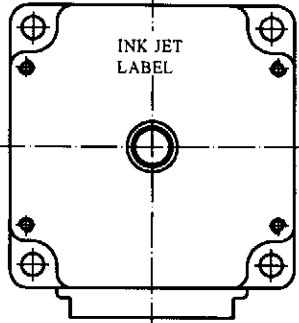
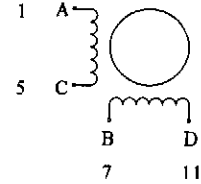

规格 Specifications

1. 相数 Number of Phase	2
2. 步距角 Step Angle	1.8°
3. 额定电压 Rated Voltage	4V DC
4. 额定电流 Rated Current	2A
5. 保持力矩 Holding Torque	1.0N.m Min. (Two phases on rated current)
6. 相电阻 Phase Resistance	2.0Ω ± 10% (20° C)
7. 相电感 Phase Inductance	7mH ± 20% (1kHz 1V rms)
8. 转子惯量 Rotor Inertia	260g.cm ²
9. 电机重量 Motor Weight	600g
10. 绝缘等级 Insulation Class	B(130° C)

励磁顺序 vs. 旋转方向
Exciting Sequence vs. Direction of Rotation

STEP	A	B	C	D	CCW
1	+	+	-	-	↑
2	-	+	+	-	
3	-	-	+	+	
4	+	-	-	+	

从安装面看为顺时针方向
Clockwise view from mounting side

铭牌 Label Detail

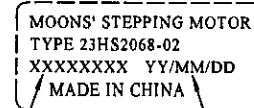

Work Order
加工单

Date Format
日期式

G			Unit: mm 第一角画法 FIRST ANGLE METHOD	批准 Approve	张明	10.24	MOONS' Hybrid Stepping Motor Shanghai Moons' Electric Co., Ltd.
F			非注维线角尺寸公差 Tolerances for linear and angular dimensions without individual tolerance indications GB/T 1804-m eqv ISO 2768-1:m 非注维线角尺寸公差 Geometrical tolerance for features without individual tolerance indications GB/T 1184-F eqv ISO 2768-2:F	标准化 Standard	张明	10.27	
E				工艺 Technology	张明	10.10.21	
D				审核 Check	张明	12.1	
C				设计 Design	周俊	2010.10.21	
B							
A	原始版本 Original revision	2010.10.21					This document is released for information only. Its reproduction in whole or in part or its dissemination to third parties is prohibited. All trademarks and registered trademarks appearing on this document are the property of their respective owners.
REV.	版本记录 REVISION RECORD	DATE	UNLESS OTHERWISE SPECIFIED	NAMES	SIGNATURE	DATE	