

# 2.54mm female Header single Straight Type

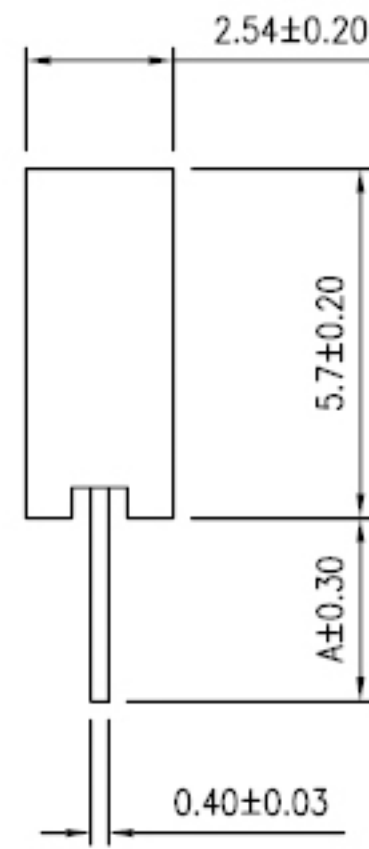
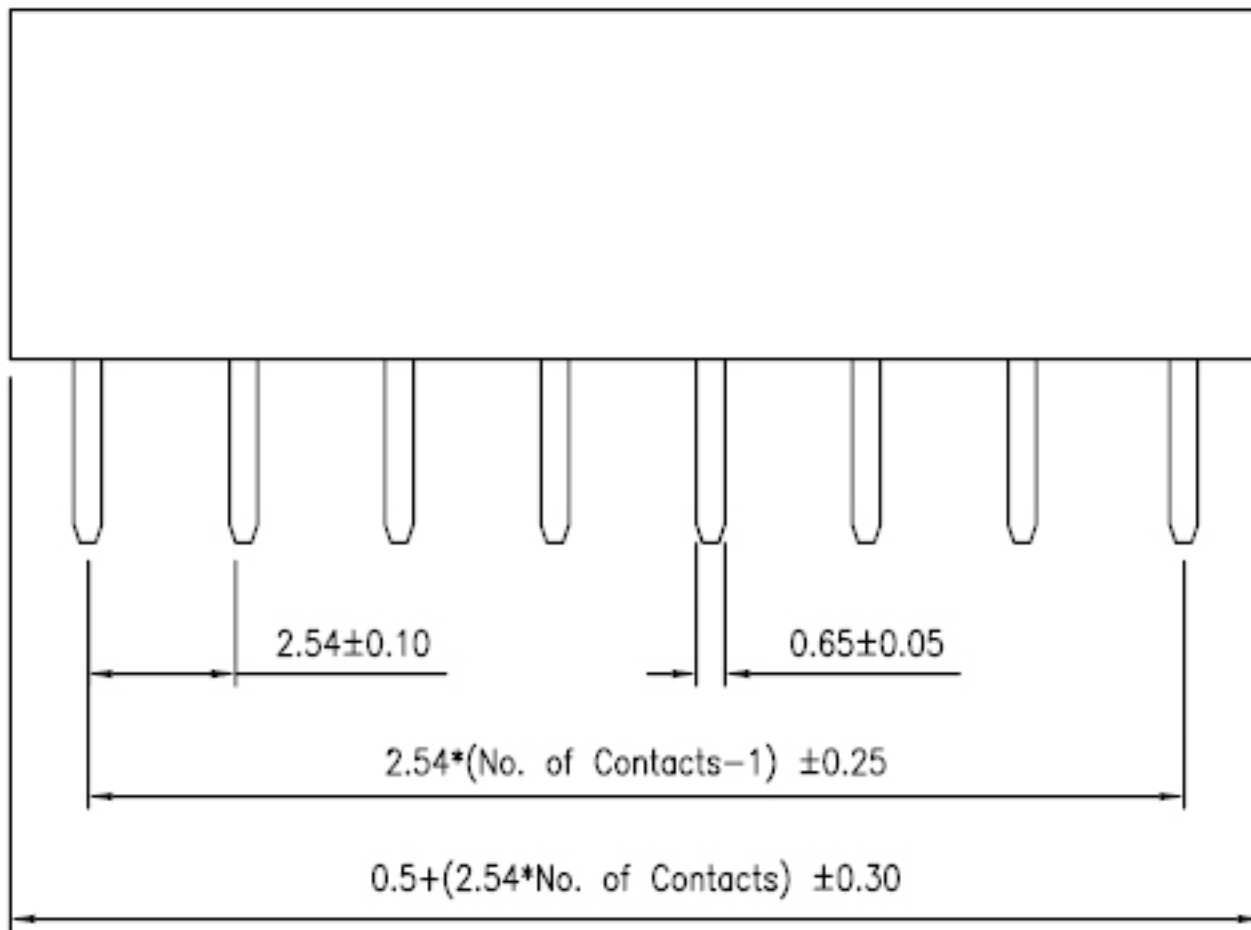
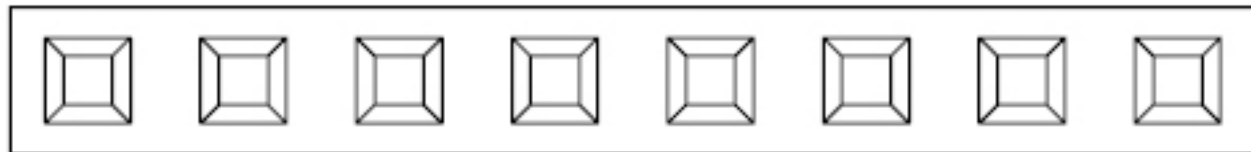

## SPECIFICATION

- \* Current Rating: 3 A
- \* Withstanding Voltage: 500 VAC ( 1 min. )
- \* Insulation Resistance: 1000 Megohms MIN.
- \* Contact Resistance: 30 Milliohms MAX.
- \* Operating Temperature: -40°C to +85°C
- \* Retention Force: 450g MIN.

## MATERIAL

- \* Contact: Brass
- \* Insulator: PBT & 30% G. F.
- \* Plated: Gold

## Pin Chart

Pin	A
1	2.8
2	
3	
4	

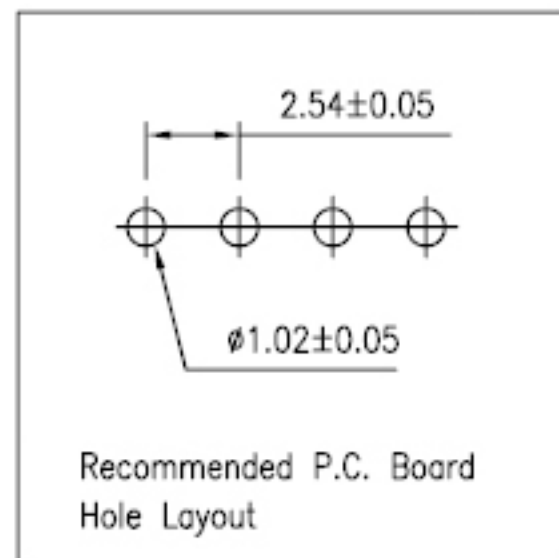

## ELEPARTS CO., LTD

0.0±	SCALE:	TITLE:	PART NO:
0.00±	UNIT: MM	2.54MM (.100") Center Female Header Single Row profile:	APP BY:
0.000±		5.7mm	CHK BY:
		MATL: PBT + 30% G.F.	DR BY:
		DWG. NO. FD21	

